

DRAFT

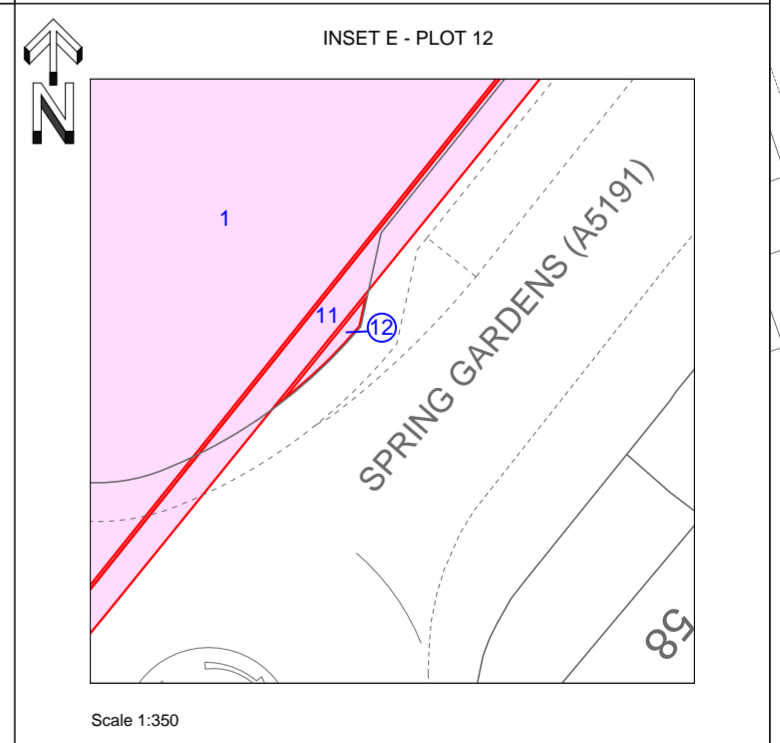
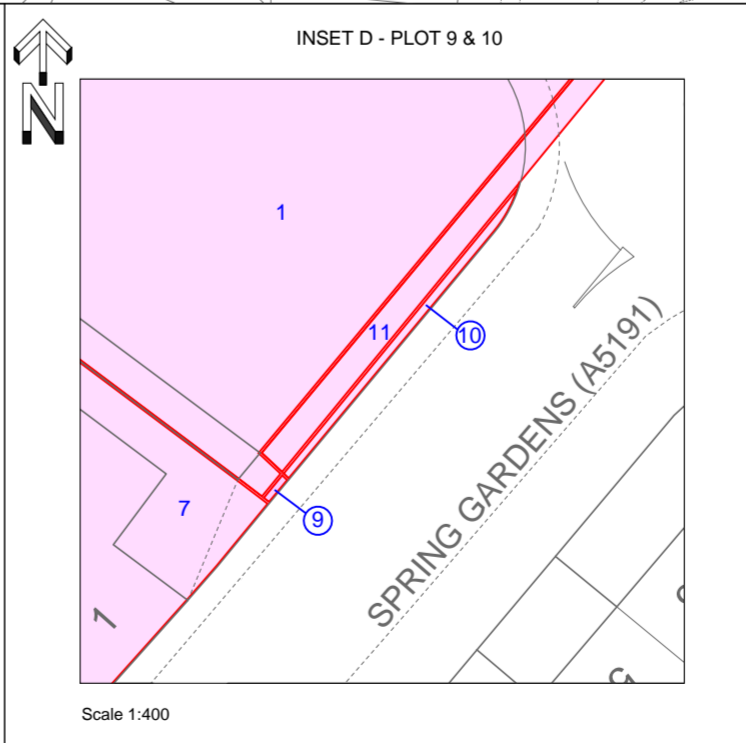
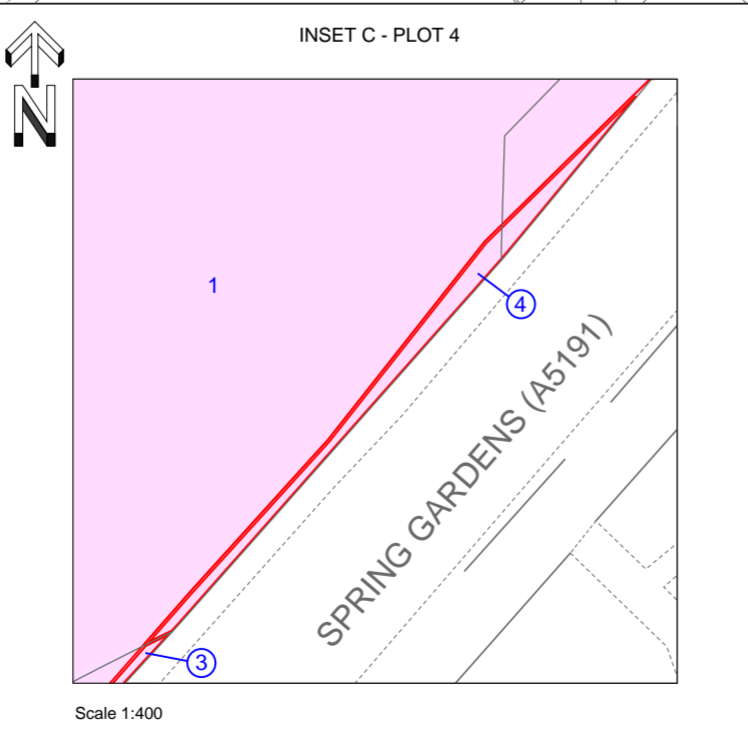
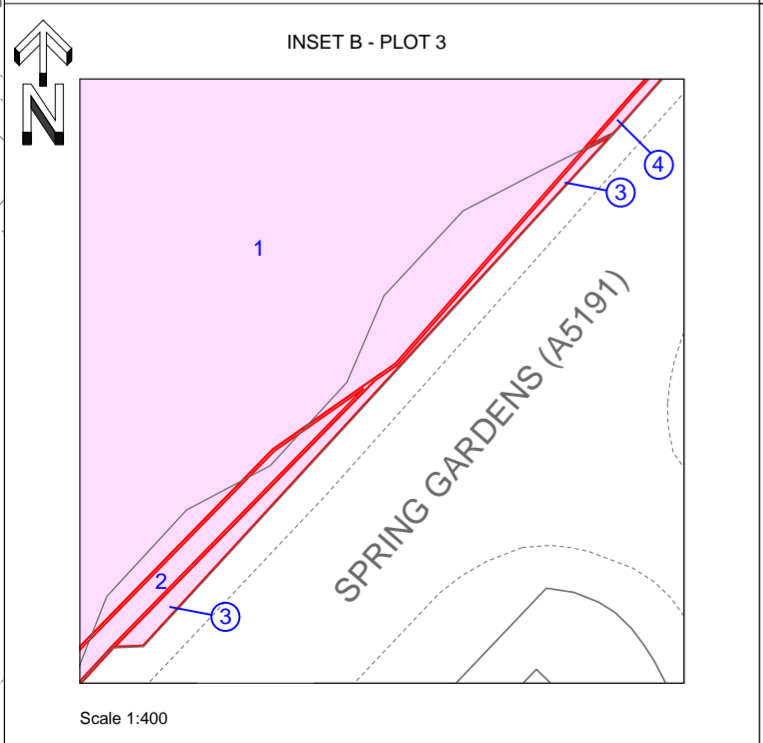
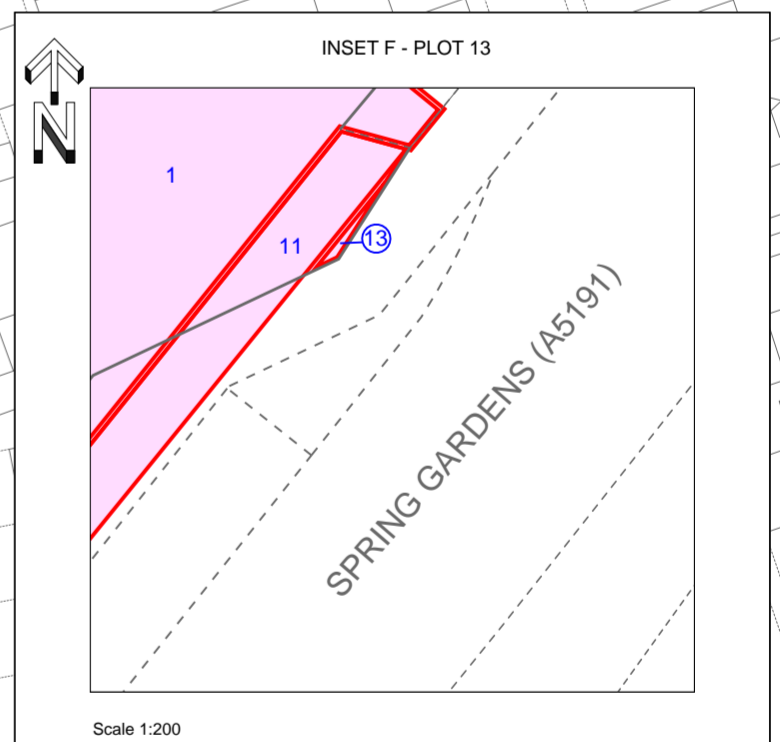
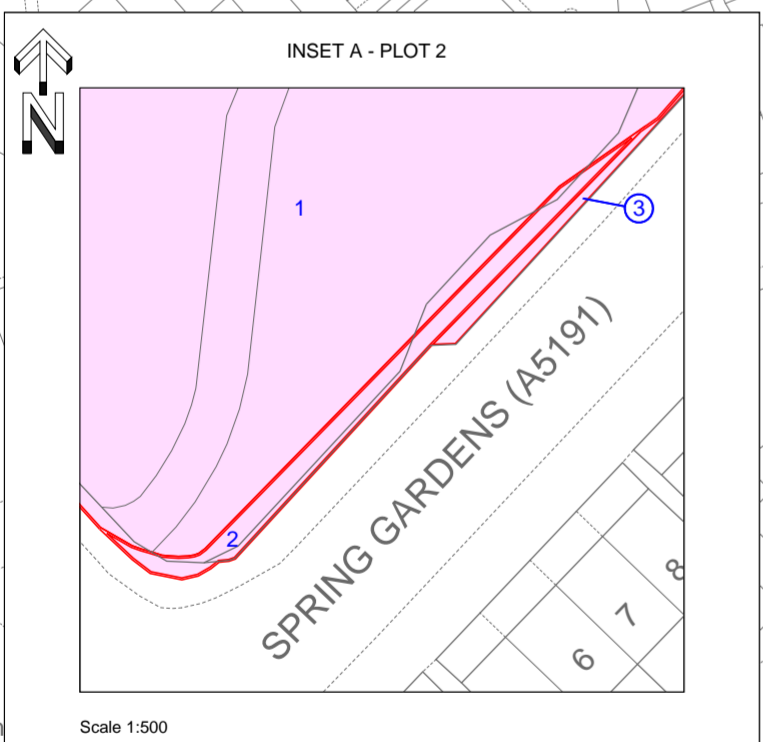
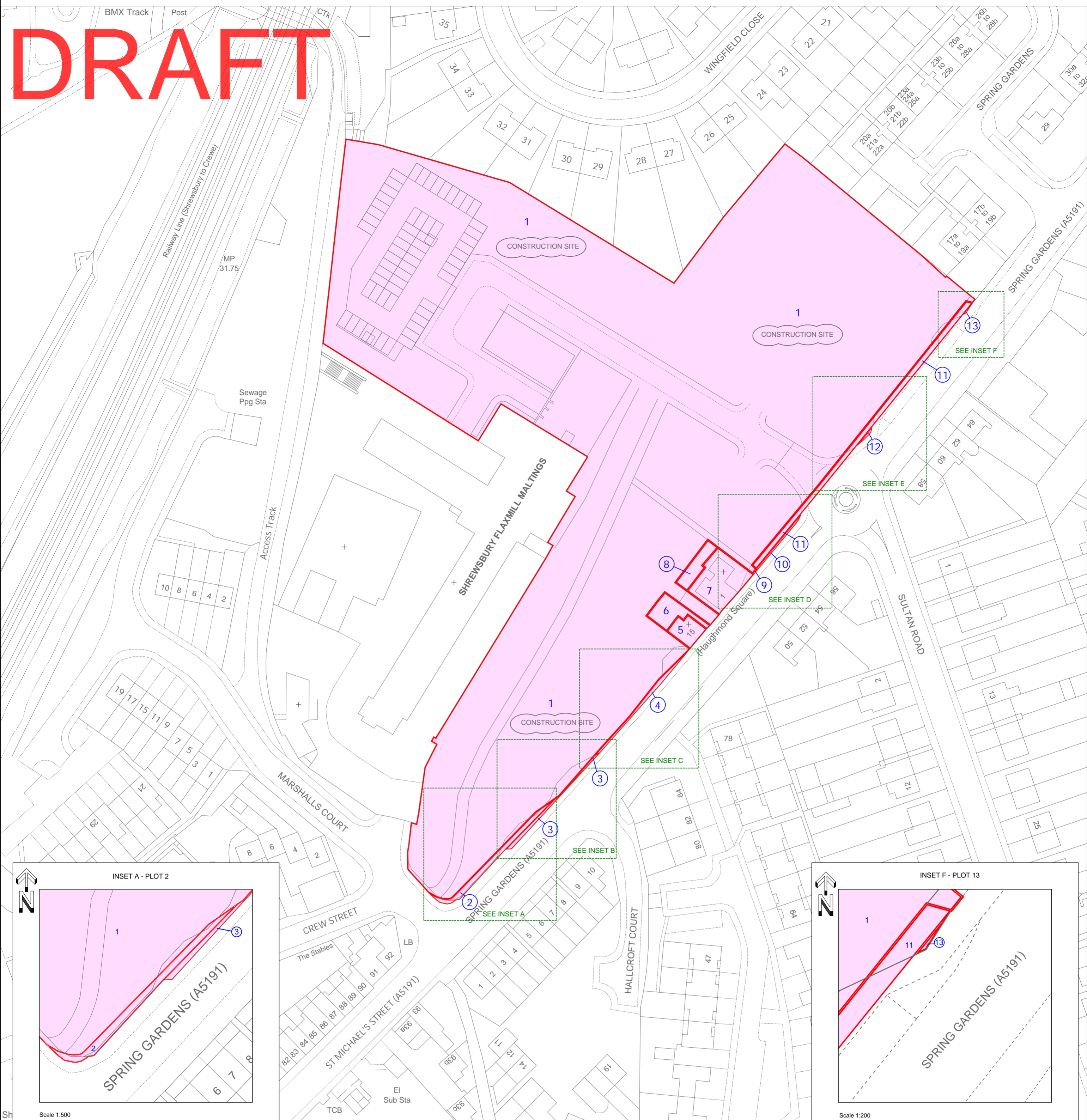
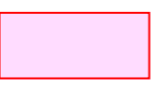

This map is based upon Ordnance Survey material with the permission of Ordnance Survey on behalf of the Controller of Her Majesty's Stationery Office © Unauthorised reproduction infringes crown copyright and may lead to prosecution or civil proceedings. © Crown copyright and database rights 2022. Ordnance Survey Licence number: 0100031673

Where applicable the plot boundaries show the general boundary of the registered land, it does not show the exact line of the boundaries. Measurements scaled from this plan may not match measurements between the same points on the ground.

KEY

 Land to be Acquired

EXECUTED as a DEED by affixing the **COMMON SEAL** of SHROPSHIRE COUNCIL in the presence of

